

## NINGALOO BLOOMING Final Installment

### *(Section 4.1)*

Take the 52 Red (Fab2) and Cream (Fab3) units (26 of each one) you completed previously (*Section 3.3*) as well as 52 cross cut Gold (fab4) and Blue (Fab1) units (*Section 2.2*) along with the 13 Green (Fab5) 2½"x 2½" squares.

Layout the above pieces as indicated by the diagram and sew together in rows watching for the pressing lines or arrows.

**You need to complete 13** of these blocks.

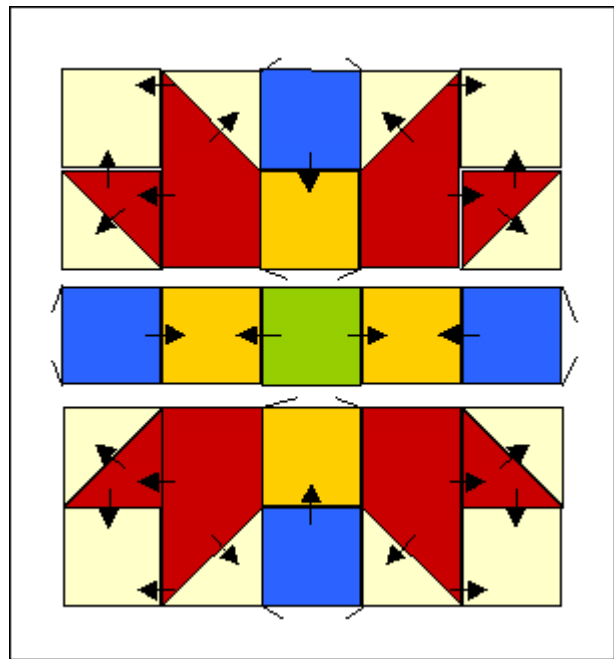

### *(Section 4.2)*

Take the units from *Section 3.4*, *Section 3.5*, and *Section 3.6*, as well as the 8 Blue (Fab1) 4½"x 10½" rectangles.

### **A Word of Warning**

When adding your 4½"x 10½" rectangle please **don't be tempted** to stretch your row to make it fit. These variations often occur - some of us sew a fat ¼" seam and others sew a scant ¼" seam. It really doesn't matter - as long as you are consistent! Measure your completed first row and if it measures 10¼" for example then trim back the rectangle to 10¼" before joining. This way you won't have a fluted edge on this block. .

This block **IS NOT** square - don't worry!

**You need to complete 8** of these blocks.

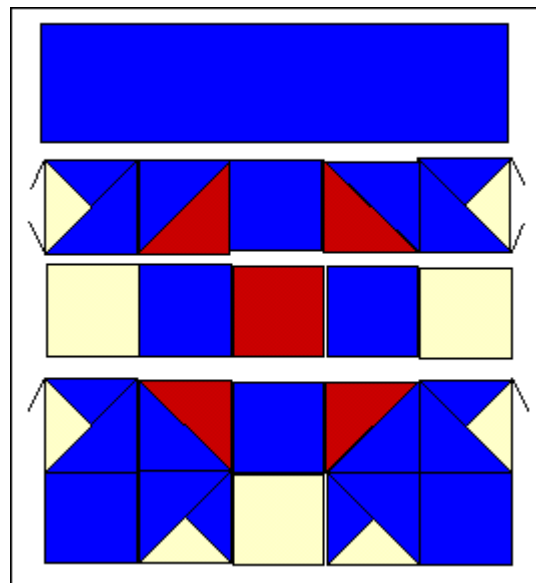

*(Section 4.3)*

Take the 16 units that you completed in *Section 2.3*, and 16 Blue (Fab1) and Cream (Fab3) cross cut units completed in *Section 2.1* along with the 4 remaining 2½"x 2½" Red (Fab2) squares.

Layout the above pieces as indicated by the diagram on the right and sew together in rows watching for the pressing lines or arrows.

**You need to complete 4** of these blocks.

In putting together this block you will need to employ the Clip & Flip pressing method where indicated by the zig zag arrows. The following diagram illustrates this method - take care not to go too close to your stitching line.

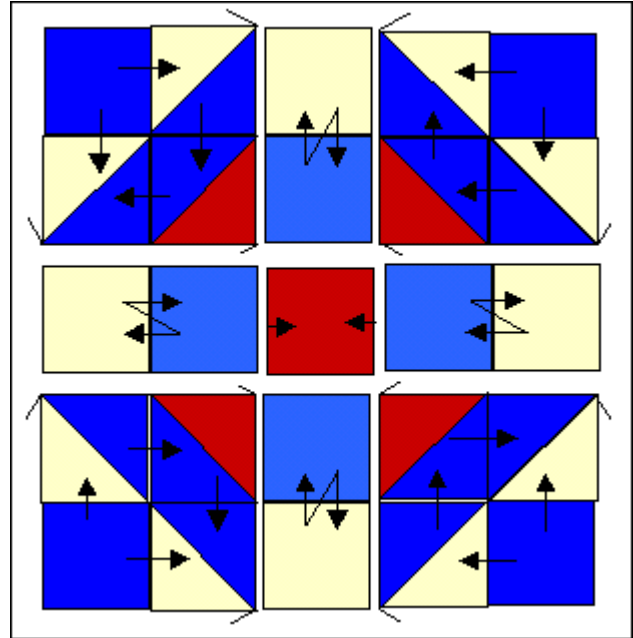
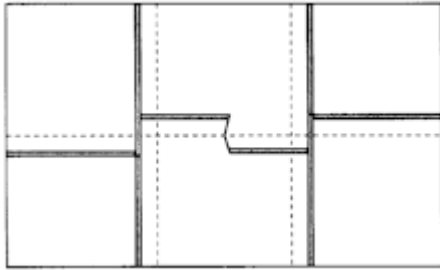

*(Section 4.4)*

Take the remaining 24 triple triangle units that you completed in *Section 2.5* along with the 12 remaining 2½" x 2½" Cream (Fab3) squares and 24 of the 2½" x 2½" Blue (Fab1) squares.

Make up **12 rows** as shown in diagram.

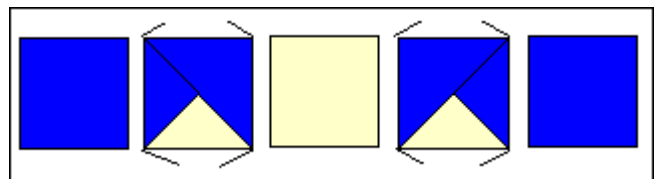

*(Section 4.5)*

The following diagram indicates the block layout which shows **non existent** sashings purely so that you can see where one block starts and another ends - Please also note that you need to have your "flower" blocks with their **long points heading northwards**.

You will need to join the units you've just completed in *Section 4.4* to your flower blocks before you begin joining your rows using the 4 remaining 2½" x 2½" Blue (Fab1) in the four corners of the quilt.

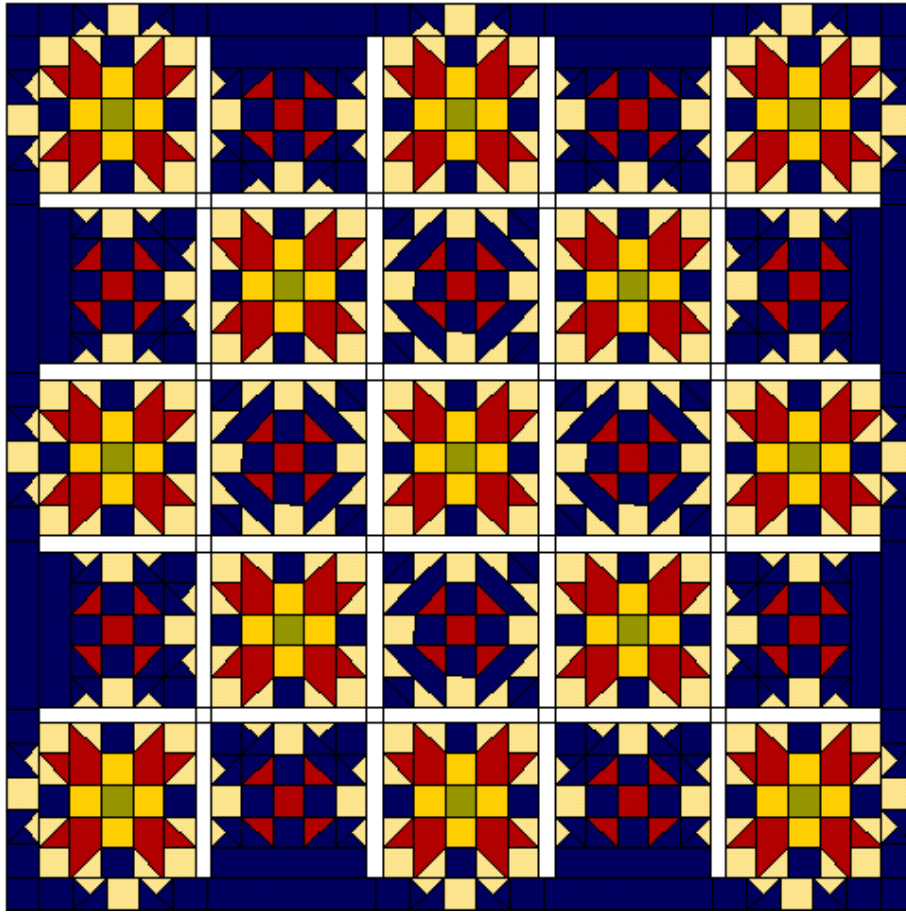

*(Section 4.6)*

Once you've got your blocks all together then take the 8 x 3" strips and use these for the outer border to give the flowers that "floating" effect. The author has allowed sufficient fabric for each border to have a central join.

Below is a photo of the author's completed top.



The author's top was then sent to Robyn Dall of Quality Quilting in Bunbury. She used an underwater theme to tie into the title of the quilt using variegated thread. The photos on this, show the quilting.

